

P E R M I T

CITY OF NAPOLEON
255 W. RIVERVIEW AVE
NAPOLEON, OHIO 43545

DIVISION OF BUILDING & ZONING
PH (419) 592-4010
FAX (419) 599-8393

PERMIT NO: 98224

DATE ISSUED: 07-16-98

ISSUED BY: BND

JOB LOCATION: 1156 WESTMONT AVE

EST. COST: 102000.00

LOT #: 41

SUBDIVISION NAME: GERKEN/HOEFFEL3

OWNER: BRUBACK, MILDRED
ADDRESS: J225 CO RD 14
CSZ: HOLGATE, OH 43527
PHONE: 419-264-4555

AGENT: BRINER, J L CONSTRUC
ADDRESS: V257 CO RD 3
CSZ: LIBERTY CENTER, OH 435
PHONE: 419-875-5466

USE TYPE - RESIDENTIAL: X

OTHER:

ZONING INFORMATION

DIST: R-2 LOT DIM: 85X120 AREA: 10200 FYRD: 30 SYRD: 10 RYRD: 15
MAX HT: 45' # PKG SPACES: 2 # LOADING SP: MAX LOT COV: 35%

BOARD OF ZONING APPEALS:

WORK TYPE - NEW: X REPLMNT: ADD'N: ALTER: REMODEL:

WORK INFORMATION

SIZE - LGTH: 55 WIDTH: 52 STORIES: 1 LIVING AREA SF: 1510
GARAGE AREA SF: 585 HEIGHT: 18 BLDG VOL DEMO PERMIT:

WORK DESCRIPTION
NEW HOME

FEE DESCRIPTION

PAID DATE

FEE AMOUNT DUE

BUILDING PERMIT		239.00
ELECTRICAL PERMIT		103.00
PLUMBING PERMIT		45.00
MECHANICAL PERMIT		22.00
WATER TAP PERMIT		655.00
SEWER PERMIT		183.00

TOTAL FEES DUE 1247.00

8-18-98

DATE

Jeff R. Briner
APPLICANT SIGNATURE

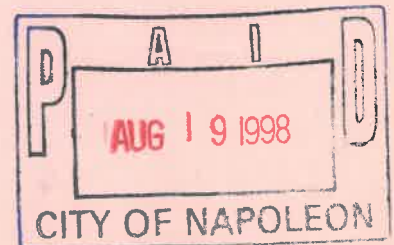

WESTMONT AVE. (60' R/W)

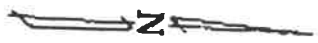
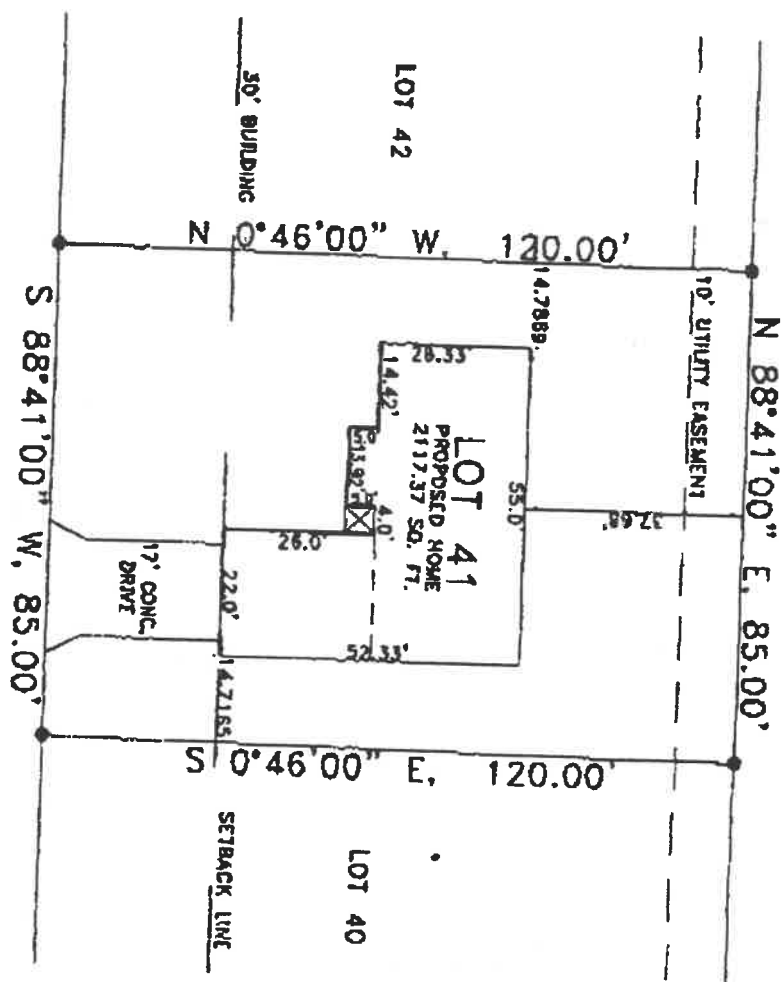

1156 Westmont
J. L. Briner

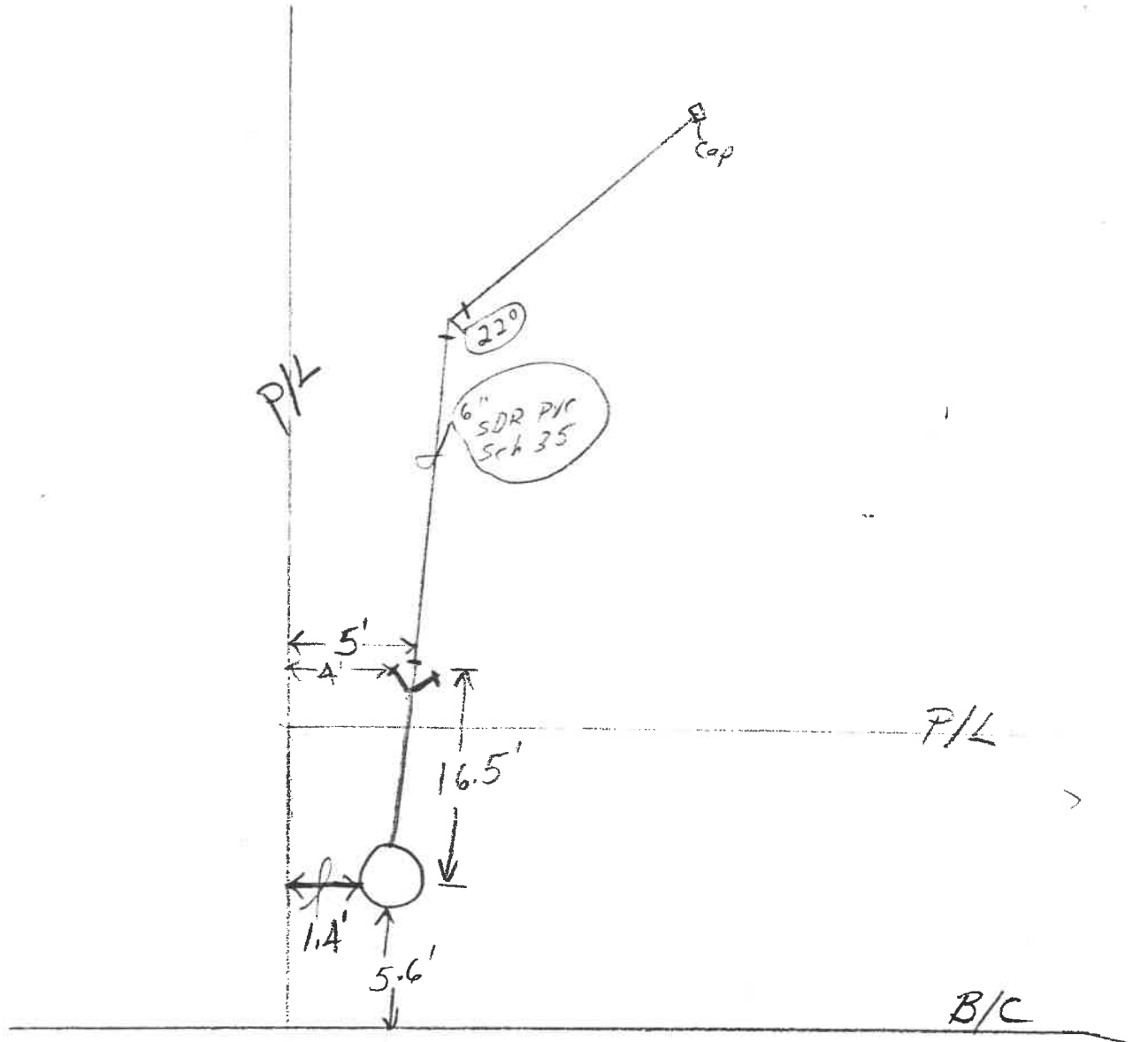

RESIDENTIAL PLAN CORRECTION SHEET

CITY OF NAPOLEON
255 West Riverview Ave.
Napoleon, Ohio 43545
(419) 592-4010

ADDENDUM TO PERMIT NO. 98224
Owner Mildred Bruback
Contractor J.L. Bruier Construction
Location 1156 Westmont Ave

Please note the items checked below and incorporate them into your plans as indicated:

- [] Permit not yet issued, correct Plans and re-submit.
[X] Permit issued, incorporate items during construction.

GENERAL

- X Provide approved smoke detector(s) as req'd.
X Provide 1/2" gypsum wallboard between dwelling and garage, on garage side.
X Provide min. 1-3/8" solid wood door from garage to dwelling (or equal).
Submit fully dimensioned plot plan.
X Provide min. of 1 - 3' 0" x 6' 8" exit door.
X Provide min. 22" x 30" attic access opening.
X Provide min. 18" x 24" crawl space access opening.
Provide approved sheathing or flashing behind masonry veneer.
X Provide min. 15# underlayment on roof.
Provide adequate fireplace hearth.
Install factory built fireplaces/stoves according to manufacturer's instructions.
Terminate chimney 2' above roof or 2' above highest point of bldg within 10' of chimney.

- Show size of members supporting porch roof.
X Provide double top plate for all bearing partitions and exterior walls.
X Provide design data for prefab wood truss.
Ceiling joists undersized in
Roof rafters undersized in

PLUMBING AND MECHANICAL

- X Terminate all exhaust systems to outside air.
X Insulate ducts in unheated areas.
X Provide backflow prevention device on all hose bibs.
X Terminate pressure and temperature relief valve drain in an approved manner.
X Provide dishwasher drain with approved air gap device.

EGRESS WINDOWS

- X All bedroom windows shall have a min. net clear opening width of 20" and a min. net clear height of 24".
X First floor bedrooms windows shall have a min. net clear opening of 5.0 s.f. Second floor bedroom windows shall have a min. net clear opening of 5.7 s.f.

LIGHT AND VENTILATION

- X Provide mechanical, exhaust or window in bathroom
Provide min. sq. in. net free area attic ventilation.
Provide min. sq. in. net free area crawl space ventilation.

(See brochure)

FOUNDATION

- X Min. depth of foundation below finished grade is 36".
X Min. size of footer 8" x 12".
X Provide anchor bolts, 1/2" @ 6' o.c. 1' from each corner. Embedded 7" in concrete and 15" in masonry. (18" bolts for masonry)
Show size of basement columns.

ELECTRICAL

- X Show location of service entrance panel and service equipment panel.
X G.F.C.I. req'd. on temporary electric.
X Outdoor, bathroom, and garage receptacles shall be protected by G.F.C.I.
X Max. number of receptacles permitted on a G.F.C.I. circuit shall be 10 for 20 A. circuits and 7 for 15 A. circuits.
X Refrigerators, microwaves, washers, disposal, furnace and air conditioners shall be on separate circuits.

FRAMING

- Show size of wood girder in
Provide design data for structural member in
Floor joists undersized in
Provide double joists under parallel bearing partitions.
Provide 1" x 4" let in corner bracing, approved sheathing, or equal.
Show size of headers for openings over 4' wide

INSPECTIONS

The following indicated inspections are req'd. The owner or his agent shall contact the City Bldg. Dept. at least 24 hrs. prior to the time the inspection is to be made.

- X Footer & setbacks X Electrical rough-in
X Foundation X Electrical - final
X Plumbing rough-in X Building sewer
X Plumbing - final X HVAC rough-in
X Electrical service X Final building
X Other before digging check stakes

Additional corrections/comments:

The approval of Plans and Specifications does not permit the violation of any Section of the Building Code or other City Ordinance. This addendum is attached to Permit No. and made a part thereof.

Date 7-16-98 X approved () disapproved Checked by Brent N. Pannman

CITY OF NAPOLEON

WATER METER YOKE RELEASE FORM

THIS DOCUMENT ENTITLES THE HOLDER TO "ONE" WATER METER YOKE ASSEMBLY
(Please pickup at City Operations Department 1775 Industrial Drive).

PERMIT #: 98224

ISSUED: 07-16-98

JOB LOCATION: 1156 WESTMONT AVE

OWNER: BRUBACK, MILDRED

PHONE: 419-264-4555

ADDRESS: J225 CO RD 14 HOLGATE, OH 43527

CONTRACTOR: BRINER, J L CONSTRUCITON

ADDRESS: V257 CO RD 3 LIBERTY CENTER, OH 43532

PHONE: 419-875-5466

WATER TAP SIZE 1" 1.5" _____ 2" _____ OTHER _____

WATER METER YOKE SIZE 5/8" 3/4" _____ 1" _____ OTHER _____

NEW STRUCTURE EXISTING STRUCTURE _____ LAWN METER _____

WATER SERVICE LINE TO BE TYPE "K" COPPER OR "CTS" POLYETHELENE TUBING OF 1" MINIMUM SIZE.

BACKFLOW DEVICE REQUIRED YES NO _____

TYPE OF BACKFLOW DEVICE REQUIRED Double check valve assembly.

WATER METER YOKE INSTALLATION IS SUBJECT TO THE FOLLOWING CONDITIONS

- 1.) MUST BE LOCATED IN AN ACCESSIBLE AREA.
- 2.) MUST BE IN AN AREA WHICH IS NOT SUBJECT TO FREEZING TEMPERATURES.
- 3.) MUST BE AT LEAST 18" ABOVE FLOOR LEVEL (NO CRAWL SPACE INSTALLATIONS).
- 4.) MUST COMPLY WITH MINIMUM MOUNTING REQUIREMENTS (DRAWING AVAILABLE)

ISSUED BY _____ RECEIVED BY _____

1-Copy to: Building Dept, Water Dept, and Utilities Dept

CITY OF NAPOLEON

ELECTRIC METER BASE RELEASE FORM

THIS DOCUMENT ENTITLES THE HOLDER TO "ONE" ELECTRIC METER BASE
(Please pickup at the City operations garage 1775 Industrial Drive).

PERMIT #: 98224

ISSUED:07-16-98

JOB LOCATION: 1156 WESTMONT AVE

WORK DESCRIPTION: NEW HOME

OWNER: BRUBACK, MILDRED

ADDRESS: J225 CO RD 14 HOLGATE, OH 43527

OWNER PHONE: 419-264-4555

CONTRACTOR: BRINER, J L CONSTRUCITON

ADDRESS: V257 CO RD 3 LIBERTY CENTER, OH 43532

CONTRACTOR PHONE: 419-875-5466

ELECTRIC SERVICE UPGRADE _____ NEW SERVICE INSTALLATION X

INDUSTRIAL _____ COMMERCIAL _____ RESIDENTIAL X 1PHASE X 3PHASE _____

SIZE OF SERVICE 100AMP _____ 150AMP _____ 200AMP X 400AMP _____ OTHER _____

HUB SIZE - 1 1/4" _____ 1 1/2" _____ 2" _____

DESIRED VOLTAGE 120/240 X OTHER _____

UNDERGROUND SERVICE X OVERHEAD SERVICE _____

=====

DATE COMPLETED: _____ APPROVED BY: _____

OLD METER NUMBER: _____ NEW METER NUMBER: _____

COMMENTS:

Facsimile Cover Sheet

To: Brent

Company:

Phone:

Fax: 599-8393

From: Lorrie Briner

Company: J.L. BRINER CONSTRUCTION CO.

Phone: 419-875-5469

Fax: 419-875-5466

Date: 9/17/98

Pages including this

cover page: 3

Comments:

Brent, I wanted to fax this because, I thought I would try to make it up to Napoleon and drop off the Installation, Structural & Performance manual. If you need I'll try to arrange it.

Lorrie Briner

Performance Sheet

STRUCTURAL AND PERFORMANCE DATA
FOR REWARD WALL SYSTEMS® FORMS

BRICK LEDGE
FORM DETAILS

REWARD WALL SYSTEMS,® Inc.

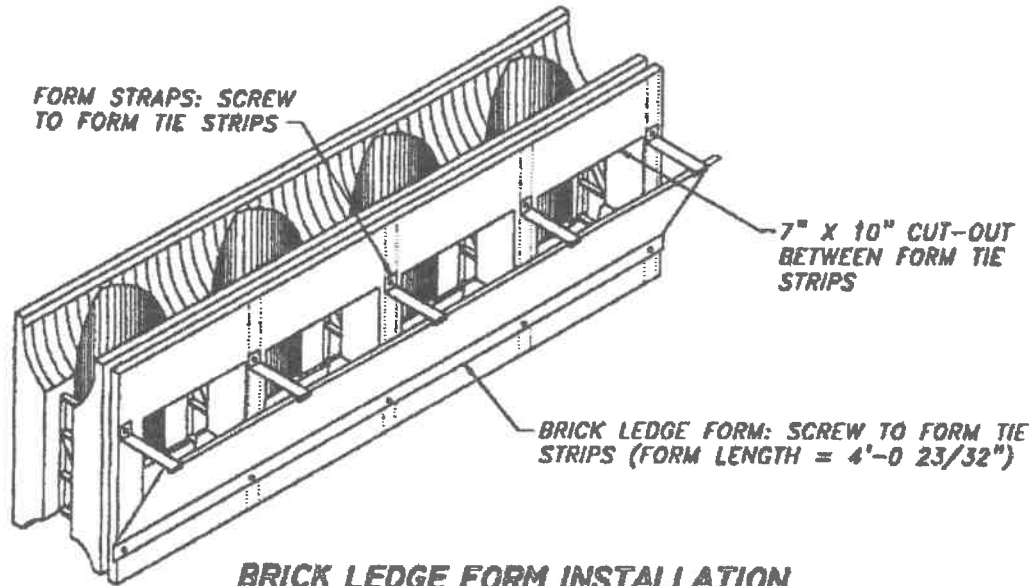

BRICK LEDGE FORM INSTALLATION

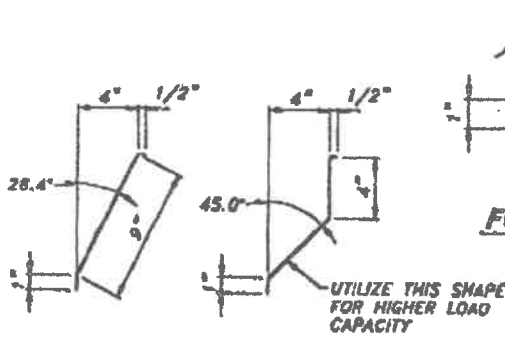

BRICK LEDGE FORM SHAPES

FABRICATE BRICK LEDGE FORMS FROM 16 GAUGE GALVANIZED STEEL SHEET, 1/2\"/>

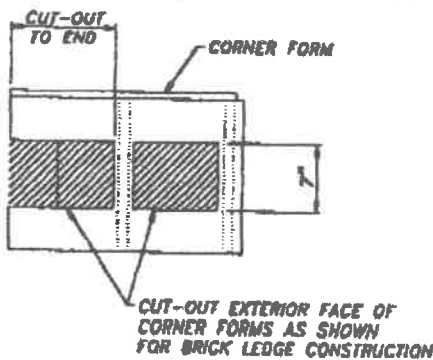

CORNER FORM DETAIL

BOTH RIGHT AND LEFT CORNER FORMS REQUIRED

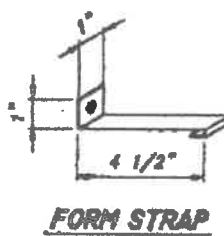

FORM STRAP

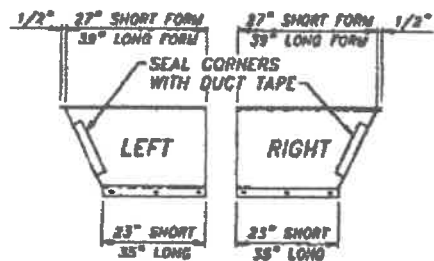

CORNER BRICK LEDGE FORMS

BOTH SHORT AND LONG SETS REQUIRED

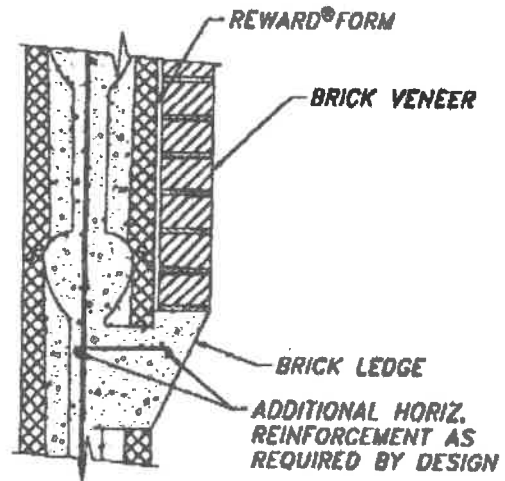

WALL SECTION AT BRICK LEDGE

Improve Your Quality Of Living With Reward Wall Systems

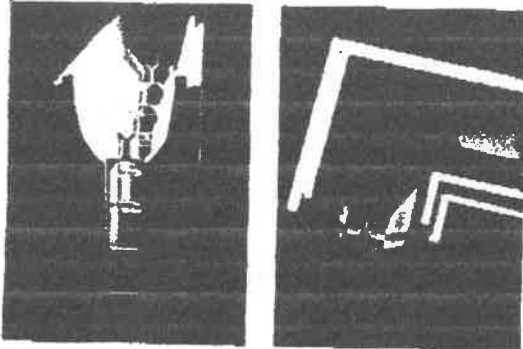

Reward Wall Systems consist of hollow sandwich forms made of two slabs of modified expanded polystyrene (EPS) foam held together with plastic form ties. Each form is 48 inches long, 16 inches high and weighs about 5 pounds. Walls are built by stacking the forms to fit together in a sturdy lap joint construction. Vertical and horizontal rebar are then fitted into the hollow core for reinforcement. Finally, concrete is placed into the core. The result is a super-insulated, airtight, steel-reinforced concrete post and beam wall. The following charts compare the attributes of Reward Wall Systems and its ranking among other forms of construction.

Ranking

Method of Construction	Reward Wall Systems	2" x 6" Stud	Concrete Block	Poured Wall
Cost Per Square Foot to Achieve R-32 Value	1st	2nd	3rd	4th
Strength Per Volume	1st	4th	3rd	2nd
Insurance Rates	1st	2nd	1st	1st
Tornado Proof	1st	3rd	2nd	1st

Attributes

Fire Resistant	Yes	No	Yes	Yes
Dust/Pollen Free	Yes	No	Yes*	Yes*
Energy/Efficiency	R-32	R-19	R-2	R-2
Air Infiltration	.09	.27	.11	.09*
Life Expectancy Without Structural Repairs	200 years	65 years	65 years	100 years
Moisture Resistant	Yes	No	No	No

* Until cracking begins

Local Representative

Advanced Form Building Inc.
V-257 County Road 3
Liberty Center, OH 43532
(419) 875-5469



4115 South 87th Street • Omaha, Nebraska 68127-1601
402-592-7077 • FAX: 402-592-7969
1-800-468-6344

E-mail: reward@rwsinc.com • Website: www.rwsinc.com

Copyright © 1998, Reward Wall Systems, Inc.

APPLICATION FOR

Residential, Building, Electrical, Plumbing, Mechanical, and Demolition Permit
FROM - The City of Napoleon, Ohio, Building Department
 255 West Riverview Avenue; P.O. Box 151; Napoleon, Ohio 43545 - Telephone (419) 592-4010

ENTRY NO. _____

PERMIT NO. _____ ISSUED _____

JOB LOCATION 1156 Westmont

LOT 41 Berken / Haeffel 3rd
 (Subdivision or Legal Description)

ISSUED BY _____
 (Building Official)

OWNER Mildred Bruback PHONE 264 4555

ADDRESS J 225 Co. Rd. 14 Holgate

AGENT J. L. Briner Const. PHONE 875-5469

ADDRESS V 257 Co. Rd. 3 Liberty Centre

USE: Residential Commercial Industrial
 Other _____

WORK: New Addition Replacement Remodel

ESTIMATED COST = \$ 102,000.00

ZONING INFORMATION

District	Lot Dimensions	Area	Front Yard	Side Yard	Rear Yard
R-2	85x120	10200	30	10	15

Max Height	No. Pkg. Spaces	No. Ldg. Spaces	Max Cover	Petition or Appeal Required-Date
45'	2		35%	

WORK INFORMATION

Building: Ground Floor Area 1510 sq. ft. Basement Floor Area _____ sq. ft.
 Garage Floor Area 585 sq. ft. 2nd Floor Area _____ sq. ft. Other Porch 22 sq. ft.
 Size: Length 55 Width 52 Stories 1 Height 18'
 Building Volume (for Demolition Permit) _____ cubic feet
 Description of Work: New Home

	Base	Plus	Total
<input checked="" type="checkbox"/> Building	\$ _____	\$ <u>239.00</u>	\$ <u>239.00</u>
<input checked="" type="checkbox"/> Electrical	\$ <u>95.00</u>	\$ <u>10.00 FE</u> <u>78.00</u>	\$ <u>103.00</u> <u>92.00</u>
<input checked="" type="checkbox"/> Plumbing	\$ <u>9.00</u>	\$ <u>36.00</u>	\$ <u>45.00</u>
<input checked="" type="checkbox"/> Mechanical	\$ <u>18.00</u>	\$ <u>4.00</u>	\$ <u>22.00</u>
<input type="checkbox"/> Demolition	\$ _____	\$ _____	\$ _____
<input type="checkbox"/> Zoning	\$ _____	\$ _____	\$ _____
<input type="checkbox"/> Sign	\$ _____	\$ _____	\$ _____
<input checked="" type="checkbox"/> Water Tap	\$ _____	\$ _____	\$ <u>653.00</u>
<input checked="" type="checkbox"/> Sewer Tap	\$ _____	\$ _____	\$ <u>183.00</u>
<input type="checkbox"/> Temp Water	\$ _____	\$ _____	\$ _____
<input type="checkbox"/> Temp Elec.	\$ _____	\$ _____	\$ _____
Additional Plan Review:	Structure _____	Electric _____	Hours _____
TOTAL FEES			\$ _____
Less Fees Paid			\$ _____
BALANCE DUE			\$ _____

CITY OF NAPOLEON INSPECTION FORM

PERMIT #: 98224

DATE ISSUED: 07-16-98

JOB LOCATION: 1156 WESTMONT AVE

OWNER: BRUBACK, MILDRED

OWNER PHONE: 419-264-4555

CONTRACTOR: BRINER, J L CONSTRUCITON

CONTRACTOR PHONE: 419-875-5466

WORK DESCRIPTION: NEW HOME

PLUMBING: UNDGR _____ RGHIN 9-22 FINAL 12-1-98

SEWER INSP _____

MECHANICAL: UNDGR _____ RGHIN 9-22 FINAL 12-1-98

FURNACE REPLC _____ AIR COND _____

ELECTRICAL: UNDGR _____ RGHIN 9-22 FINAL 12-1-98

SERV UPGR _____

BUILDING: SITE 8-3 FTG 8-17 FNDDT 8-31

STRUC 9-22 ROOF 9-22 EXT _____

VENT _____ ACCES _____ EGRS _____

SMKDT _____ FINAL 12-1-98

ISSUE TEMP OCCUP _____ ISSUE OCCUP ✓ 12-31-98

STRG SHED: SITE _____ FINAL _____

SIGN: FTG _____ FINAL _____

FENCE: SITE _____ FINAL _____

MISC INSP: _____

NOTES: _____

CITY OF NAPOLEON WATER TAPPING PERMIT FORM

PERMIT #: 98224

ISSUED: 07-16-98

JOB LOCATION: 1156 WESTMONT AVE

SUBDIVISION NAME: Gerken/Hoeffel 3rd LOT #: 41

OWNER: BRUBACK, MILDRED

ADDRESS: J225 CO RD 14 HOLGATE, OH 43527

CONTRACTOR: BRINER, J L CONSTRUCITON PHONE: 419-875-5466

TAP SIZE: 1" X 1.5" _____ 2" _____ OTHER _____

AMOUNT PAID: 650.00 YOKE SIZE: 5/8"

PLUMBING CONTRACTOR: _____ PH: _____

DATE OF TAP: 10-20-98 OLD TAP #: _____ NEW TAP #: 9868

SIZE AND KIND OF MAIN: 8" C-900

LOCATION OF MAIN: 10' South of South curb DEPTH OF MAIN: 5'

DIST FROM HYDRANT ~~TO~~: 46' West of Hyd⁴⁵⁴ DIST TO CURB STOP FROM CORP: 54'

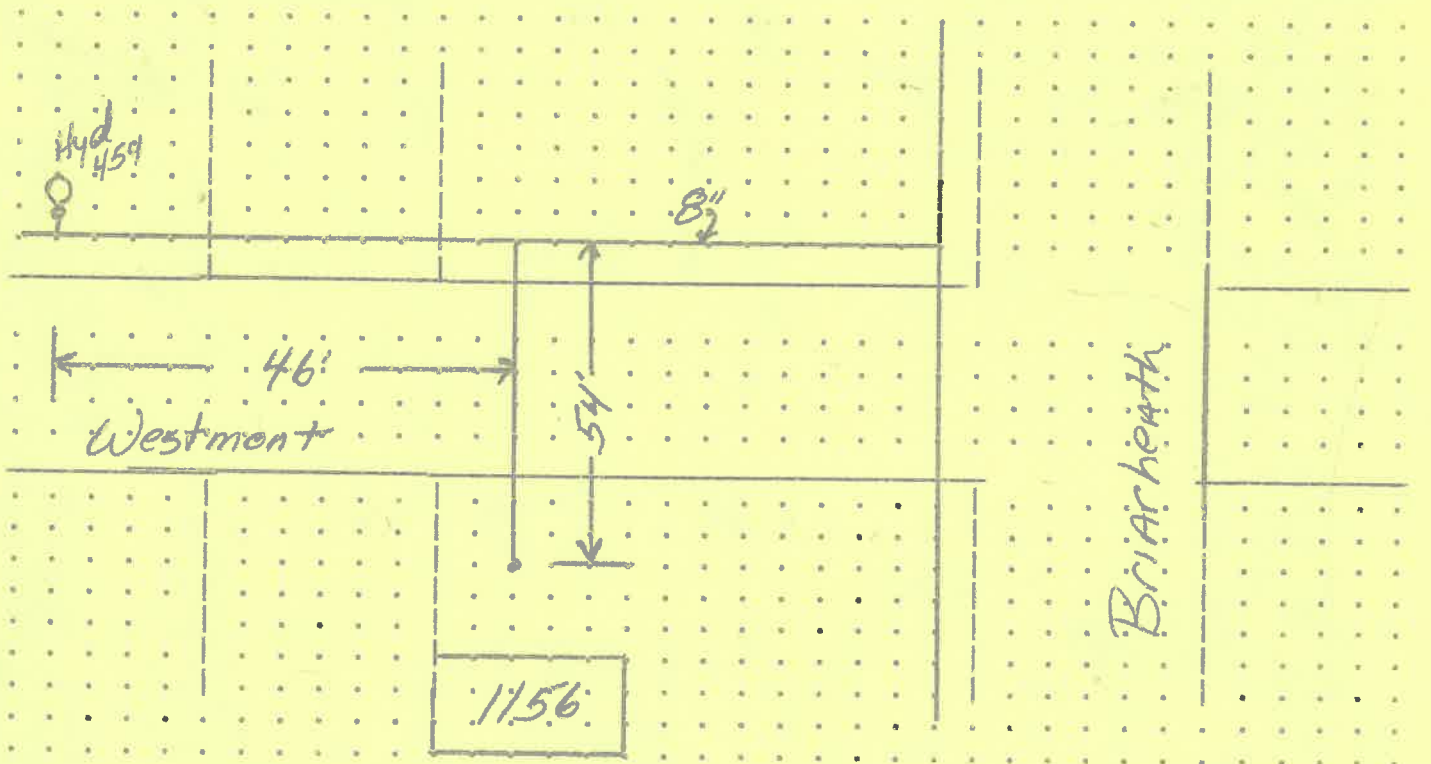

DATE APPROVED: Dec. 21, 1998 BY: Jffrey C. Mantel

No. 503

CERTIFICATE OF OCCUPANCY
THE CITY OF NAPOLEON
ENGINEERING DEPARTMENT
DIVISION OF INSPECTION

This is to certify that the Building or Land as herein described complies with all the building and health laws and ordinances and with the provisions of the Zoning Ordinance.

Location of Occupancy ... 1156 Westmont Ave ... Occupancy ... Single Family

Owner of Property ... Michael Bruck ... Address ... 1156 Westmont Ave

Issued to ... [Signature] ... Address ...

Zoning ... R-2 Single Family Residential ... Bldg. Permi No. ... 98224

Substantial qualifications of occupancy ... Substantial City Code Compliance

Not reaching to be completed prior of 1999

This certificate is issued by the City Building Inspector, as provided by law, and is to certify that construction is completed substantially in conformity with the approved plans and permission is hereby granted to occupy such building in compliance with such legal use and occupancy as authorized under the provisions of the ordinances of the City of Napoleon.

Issued this 30th day of December 1998

This is a valuable record for owner or lessee and should be so preserved.

Signed [Signature] City Building Inspector